

# Jack PC - Installation Guide

English



Complete your SBC Solution by Using Xcalibur Global Management Software

Chip PC HQ  
Tel: +972 (0) 4 850 11 21  
info@chippc.com

Chip PC Germany  
Tel: +49 (0) 201 4513 100  
Tel: +49 (0) 89 5171 7562  
info@chippc.de

Chip PC UK  
Tel: +44 (0) 870 606 1007  
info@chippc.co.uk

Chip PC France  
Tel: +33 (0) 6 11 42 07 84  
info.fr@chippc.com

Chip PC US  
Toll Free: +1 866 674 1678  
Tel: +1 972 827 0379  
info.us@chippc.com



REV.12.08-A  
EU/UK / CMD04542  
www.chippc.com

Chip PC Technologies

www.chippc.com

Chip PC Technologies

www.chippc.com

Chip PC Technologies - Making IT a Complete Solution

## Box Content

Unpack and identify the following parts:

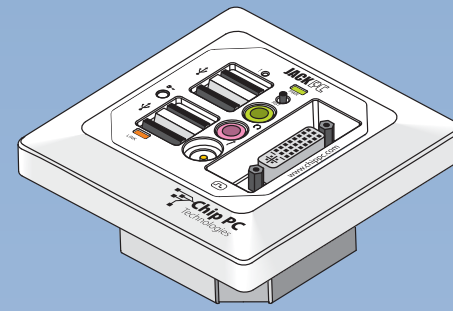

Jack PC device

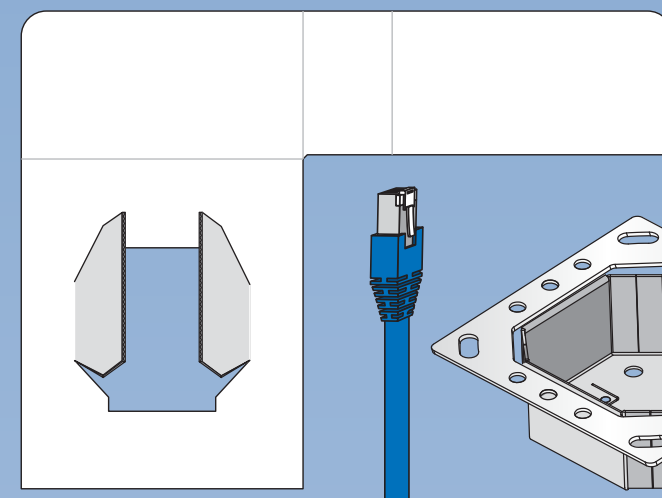

Lower Cardboard Template that can be used for marking wall cutout in New Installation

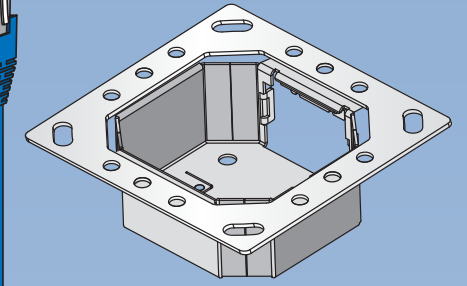

Metal Housing for Jack PC

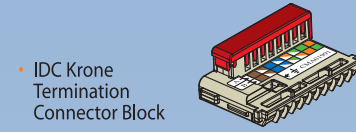

IDC Krone Termination Connector Block

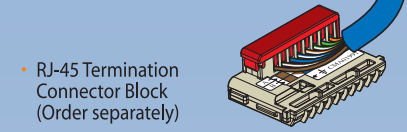

RJ-45 Termination Connector Block (Order separately)

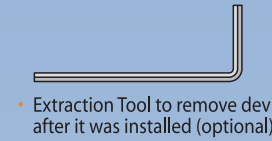

Extraction Tool to remove device after it was installed (optional)

## Existing Jack Installation

Tools you will need:

- Power-over-Ethernet Tester
- Screwdriver/Electric screwdriver
- RJ-45 Termination Connector Block - to be purchased separately from Chip PC
- Half-round File to trim wall cutout
- Cloth to clean Housing contacts
- Extraction Tool to remove device after it was installed



Use Power-over-Ethernet tester to check existence of PoE in the Jack designated for installation.  
**Note:** In case there is no PoE available, Jack PC can be powered by External power supply (see step 13).



Remove the existing LAN Jack from the wall. Separate the LAN Jack module from the front panel.



Pull out the LAN cable. Take the RJ-45 Termination Connector Block, which is not supplied in default packaging and needs to be purchased separately.



Connect the LAN jack and RJ-45 connector on the RJ-45 Termination Connector Block.



Insert the RJ-45 Termination Connector Block into the Housing bottom part until you hear a clicking sound indicating it has locked properly into place.



Place Housing inside the wall cutout. Trim wall cutout if necessary.

## New Installation

Tools you will need:

- Drill with 65 mm (2.6 Inch) Hole Saw
- Half-round File to trim wall cutout
- Cutter to remove LAN cable insulation
- IDC Krone punch-down tool to secure wires
- Cloth to clean Housing contacts
- Screwdriver/Electric screwdriver
- Extraction Tool to remove device after it was installed



Use the lower Cardboard template supplied in packaging to mark the designated wall cutout for the Housing installation.



Drill the wall cut out at the designated location.  
**Warning!** Make sure not to drill next to electricity / telephone lines. Test for existence of power lines or enforcement beams prior to drilling the wall cutout.



Trim the cutout gently and check that the Housing fits in properly.



Pull out the LAN cable and remove 4cm/1.5 inch of its plastic insulation. Separate wire pairs by color.

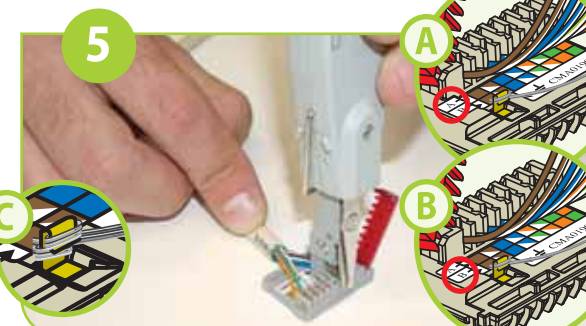

Open the IDC Block red cover. Secure the wires with an IDC Krone tool, using the appropriate color scheme TIA568 version A or B (pic. "A", "B"). When using a shielded LAN cable, wrap the Shield wire around the metal Tab (pic. "C").



Close the IDC Krone Termination Connector Block and insert it into the Housing bottom part until you hear a clicking sound indicating it has locked properly into place.



Make sure that the Housing is fully inserted, level-headed and Housing contacts are located at the bottom part as shown in picture. Secure with 4 screws.



Gently clean the Housing contacts from dust and other objects.



The Jack PC device should be inserted with contacts shown in picture facing downwards enabling direct contact with the Housing contacts.



Insert the Jack PC device into the Housing until you hear a clicking sound indicating the device has locked properly into place. Verify locking by gently pulling device outwards.



**Note:** in case you need to remove device after it was installed, unlock device by using the Extraction Tool turned clockwise.



Connect Keyboard, Mouse, Monitor and any other required peripheral to device ports.



Some models offer dual-screen support. In order to get this functionality, connect Y-cable to the DVI monitor port. The Y-cable is to be purchased separately as accessory from Chip PC.



To power the device from an external power source, connect Chip PC-supplied power supply to the DC power jack. The power supply is to be purchased separately as accessory from Chip PC.

Additional Jack PC technical documentation can be downloaded from: [www.chippc.com](http://www.chippc.com)

# Installation Options

## Wall Installation



## Floor Box Installation

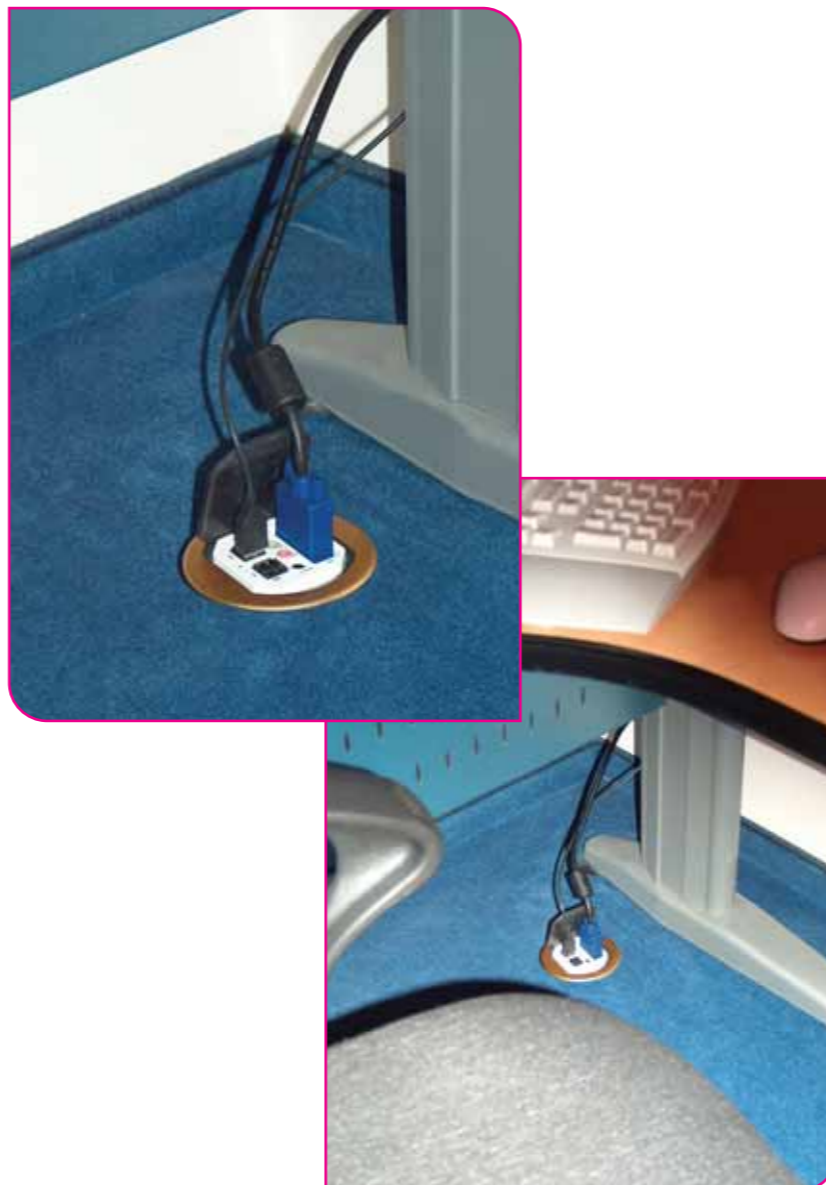

## Furniture Installation



# Power Options

### Option 1 - PoE LAN Switch Available

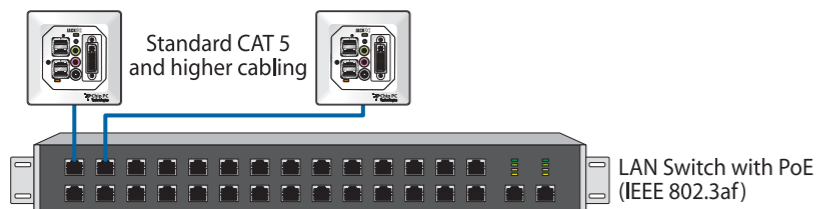

### Option 2 - Standard LAN Switch + Midspan PoE Injector

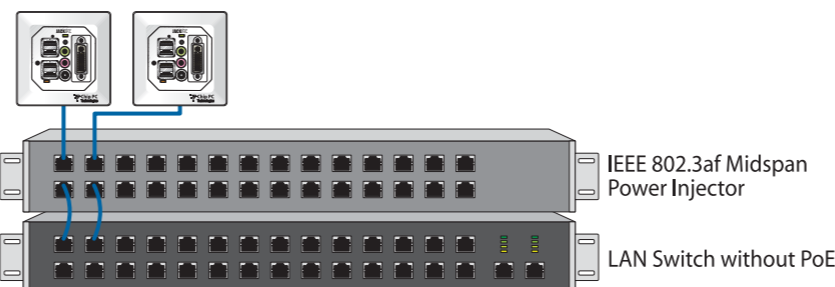

### Option 3 - Standard LAN Switch + External Power Supply

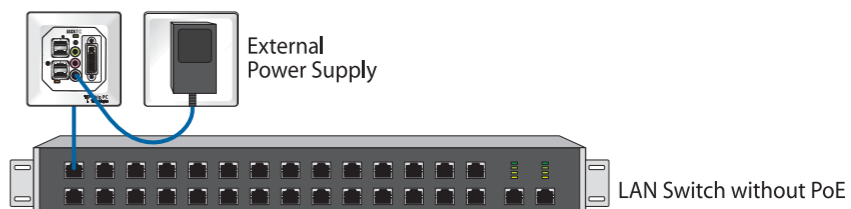

# Accessories

### Installation Options

CPN02163  
IDC Krone Termination Kit



CPN02164  
RJ-45 Termination Kit

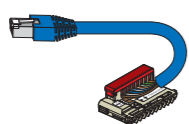

CPN02172  
External Mounting Box - EU/UK

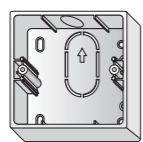

CPN02431  
Wall-Side Frame - EU/UK

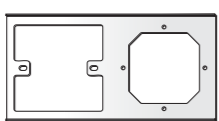

### Ports Adapter Converters/Cables

CPN01487  
USB to PS/2 Ports Adapter



### Power-over-Ethernet

CPN02216  
Power-over-Ethernet Midspan Injector - EU (Single Port, for Evaluation)

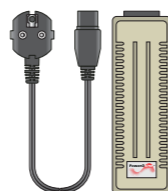

CPN02243  
Power-over-Ethernet Midspan Injector - UK (Single Port, for Evaluation)

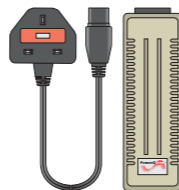

CPN02239  
Power-over-Ethernet Tester



### Y Cables & Converters

CPN02176  
Dual-screen Y-Cable DVI-I to DVI-D and VGA

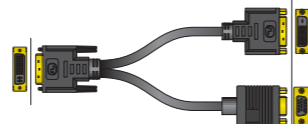

CPN02159  
DVI-I to VGA Adapter



### Powering

CPN02506  
Power Supply, wall-mount, EU ROHS, 100-240VAC, 5VDC, 2.0A



CPN02507  
Power Supply, wall-mount, UK ROHS, 100-240VAC, 5VDC, 2.0A

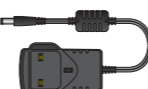

CPN03789  
USB Power Cable - Single, 6 ft (1.8m)

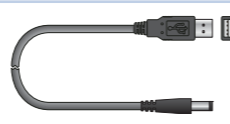

CPN03788  
USB Power Cable - Dual, 6 ft (1.8m)

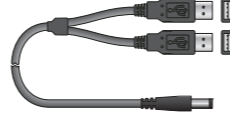

### External USB Smart Card Readers

CPN02663  
SCM SCR-3310 External USB PC/SC Smart-Card Reader



CPN02664  
SCM SCR-3311 External USB PC/SC Smart-Card Reader

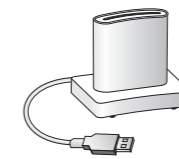

CPN01804  
SCM SCR-335 External USB PC/SC Smart-Card Reader



### Miscellaneous

CPN02167  
Housing - EU/UK

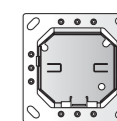

CPN02171  
Extraction Tool, T-6



CPN02248  
IDC Krone Punch-Down Tool

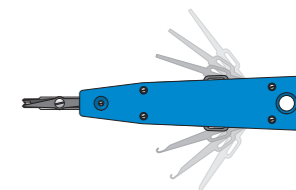

CPN02289  
Short LAN Jumper Cable (two RJ-45)



CPN02434  
RJ-45 to RJ-45 coupler (Female-to-Female)

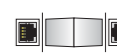

Check Chip PC website for accessories fit for other geographical building and network standards